

# 42" Slab

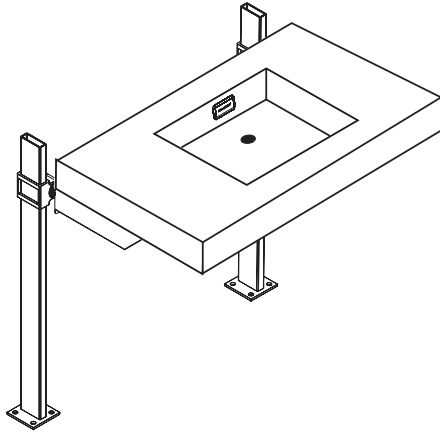

**Model Shown: 9114-WM-MC-FLR-CTR-H0**  
 42" Slab Deck with Commercial Floor Mounted Arm/Carrier, Integrated Basin  
 Centered on Deck, No Faucet Drilling

- **WALL MOUNTED 42" LENGTH SOLID SURFACE DECK WITH INTEGRATED BASIN**
- **ENTIRELY CASTED IN ONE PIECE OF WHITE-COLORED, OPAQUE, RECYCLED/ RECYCLEABLE POLYMER BIO-RESIN**
- **INTEGRAL BASIN 17" X 14" X 4" DEPTH IS CENTERED ON DECK**
- **ACCOMMODATES SUPPLIED RESIDENTIAL/LIGHT COMMERCIAL MOUNTING CARRIER (HEAVY-DUTY COMMERCIAL FLOOR MOUNTED CARRIER IS ALSO AVAILABLE)**
- **INTEGRATED OVERFLOW WASTE OUTLET**
- **MEETS ADA COMPLIANCY**

DESCRIPTION	MODEL/OPTION #
<b>A ORIENTATION</b> - Required Selection <span style="float:right">INIT. <input type="text"/></span>	
<input type="checkbox"/> Wall Mounted Deck includes Wall Carrier - MC	9114-WM
<input type="checkbox"/> Standard Arm/ Wall Mounted Carrier Suggested for residential/ light commercial applications	-MC
<input type="checkbox"/> Commercial Floor Mounted Arm/Carrier Required for commercial application (requires 2" x 6" wall construction)	-MC-FLR
<b>CONSTRUCTION INFORMATION Must specify -</b>	
Wall Thickness: _____	
Wall Type _____	

Add (+)	<b>B SOLID SURFACE COLOR</b> - Required Selection <span style="float:right">INIT. <input type="text"/></span>	
<input type="checkbox"/>	<b>Blanco</b> (White)	-RDC10
<input type="checkbox"/>	<b>Grey Goose</b> (Gray)	-RDC14
<input type="checkbox"/>	<b>Anise</b> (Black)	-RDC16

Add (+)	<b>C BASIN SELECTION</b> - Required Selection <span style="float:right">INIT. <input type="text"/></span>	
<input type="checkbox"/>	<b>Square Basin</b> 14" L x 14" W x 4" H Basin (356 x 356 x 102 mm)	-BBSQ
<input type="checkbox"/>	<b>Oval Basin</b> 14" L x 17" W Basin (356 x 432 mm)	-BBOV
<input type="checkbox"/>	<b>Round Basin</b> Ø16" Basin (Ø 406 mm)	-BBRD
<input type="checkbox"/>	<b>Ramp Basin</b> 14" L x 17" W Basin (356 x 432 mm)	-BBRA
<input type="checkbox"/>	<b>Rectangular Basin</b> 33" x 14" Basin (-DBL Not Available) ( 838 x 356 x 102 mm)	-3676

Overflow Waste is Built-in  
 Specify Plate Finish:  
 Satin (Standard)  High Polish

**REQUIRED**

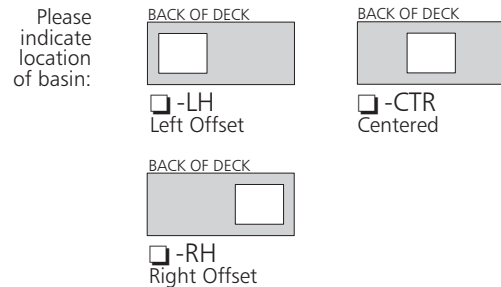

Add (+)	<b>D FAUCET CONFIG.</b> - Optional Selection <span style="float:right">INIT. <input type="text"/></span>	
<input type="checkbox"/>	<b>No Faucet Hole</b> For wall mounted faucet	-H0
<input type="checkbox"/>	<b>Single Hole</b> Ø1-5/16" Centered Hole	-H1
<input type="checkbox"/>	<b>6" Centerset</b> (152 mm)	-H36
<input type="checkbox"/>	<b>8" Centerset</b> (203 mm)	-H38

Customer is required to submit faucet spec sheet to confirm compatibility with Neo-Metro's faucet drilling.

Add (+)	<b>E TRAP ENCLOSURE CONFIG.</b> - Optional Selection <span style="float:right">INIT. <input type="text"/></span>	
<input type="checkbox"/>	<b>Trap Enclosure</b>	-TE



Member of  
U.S. Green  
Building  
Council



Recyclable  
Product

# 42" Slab®

**PRODUCT Specification . . .** The Slab is a one-piece, solid surface deck with an integral basin. The 42" Slab deck measures 42" x 22" x 4" (1,067 x 559 x 102mm). **The unit is casted** in a white-colored, opaque, polymer bio-resin solid surface material. The resin contains recycled and recycleable content. The durable deck is resistant to cracking and has excellent thermal shock performance.

**The deck is configured for standard mounting (-MC)** which includes an arm/wall mounted carrier appropriate for residential or light commercial applications. An optional commercial floor mounted arm/carrier (-MC-FLR) is available for heavier commercial application and requires a 2" x 6" wall construction. Both carrier systems are concealed in the wall; therefore, installation must be coordinated before wall is finished.

**The integral basin, 14" x 17" x 4" depth (356 x 432 x 102mm)** is centered (-CTR) on the 42" (1,067mm) deck leaving 12-1/2" (316mm) counter space on both sides.

**A standard 1-1/4" drain hole** is provided to accommodate any drain assembly with overflow (drain and P-trap not included).

**An overflow waste channel** is also integrated in the cast basin, draining into the drain assembly. A Satin Finish stainless steel cover is provided. High Polish cover may also be specified.

 **The 42" Slab unit is ADA compliant** if installed properly. (Compliance is subject to the interpretation and requirements of the local code authority. Please check your local ADA requirements.)

**Faucets are not supplied** but 1-5/16" (33mm) holes can be drilled in a pre-configured single-hole (-H1), 6-inch (152mm) centerset (-H36), 8-inch (203mm) centerset (-H38) and a No Hole option (-H0), typically for wall mounted faucets. Neo-Metro requires customers to submit specification sheet of faucet to confirm compatibility. Custom faucet configurations may be specified by submitting a completed and signed Faucet Drilling Worksheet.

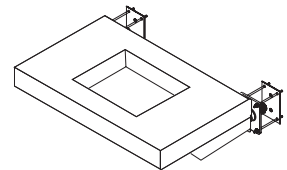
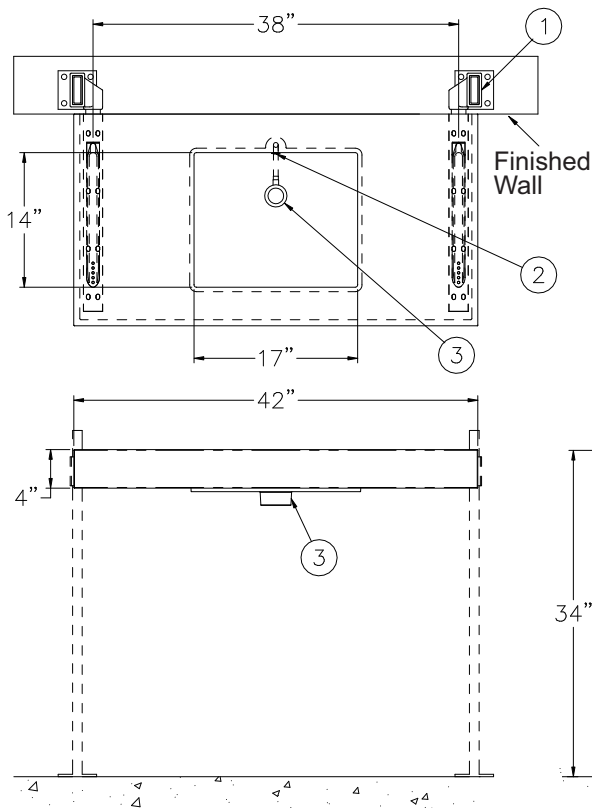

**Model Shown: 9114-WM-MC-CTR**  
42" Slab Deck with Standard  
Arm/Wall Mounted Carrier

- ① Optional Concealed Floor Mounted Carrier Must Specify (-MC-FLR)
- ② Overflow Waste Outlet (Standard)
- ③ Waste Opening Intended for 1-1/4" Nominal OD Outlet (provided by others)

All dimensions are subject to manufacturer's tolerance of plus or minus 1/2" nominal and subject to change without notice. assumes no responsibility for use of void or superseded data. Neo-Metro, City of Industry, CA, Member of Morris Group International. Please visit [www.acorneng.com](http://www.acorneng.com) for most current specifications.

 **APPROVAL FOR MANUFACTURE**

COMPANY: \_\_\_\_\_

PROJECT NAME: \_\_\_\_\_

SIGNEE'S NAME WRITTEN CLEARLY: \_\_\_\_\_

DATE: \_\_\_\_\_

AUTHORIZED SIGNATURE: \_\_\_\_\_

 **WARNING:** Cancer and Reproductive Harm - [www.P65Warnings.ca.gov](http://www.P65Warnings.ca.gov)